

6A1-14301-03 NEW (Factory No.:JP11YA) -YAMA JAPAN



6A1-14301-03-00,6A1-14301-03 / 6A1-14301-00/01/02, for 2 Stroke 30HP 2HP 2A YAMAHA Outboard Motors Engine boat motor

Item specifics
 Condition:New Produced
 Fit Yamaha
 Motor & Engine Type: Outboard Motors
 Manufacturer Part Number: 6A1-14301-03/01
 YAMA JIAPAN Can produce high quality marine carburetor fit for YAMAHA OUTBOARD Carburetor Assembly (Intake) for 2 A B horsepower 2 stroke engines.

This CARBURETOR ASSY parts 6A1-14301-03-00 is also used on these models and components:

- 1994 2MSHS CARBURETOR
- 1995 2MSHT CARBURETOR
- 1996 2MSHU CARBURETOR
- 1997 2MSHV CARBURETOR
- 1998 2MSHW CARBURETOR
- 1999 2MSHX CARBURETOR
- 2000 2MSHY CARBURETOR
- 2001 2MSHKZ CARBURETOR
- 2001 2MSHZ CARBURETOR
- 2002 2MSHA CARBURETOR

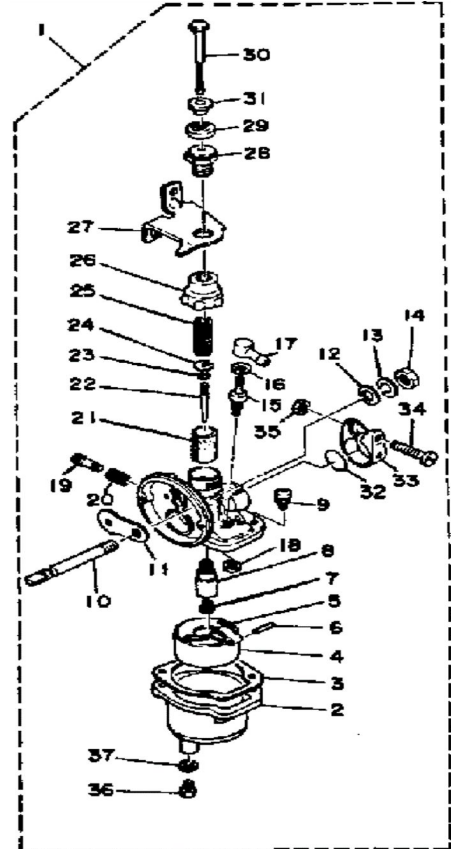

YAMA JIAPAN Carburetor Co.,Ltd.
Factory Plant Location
 Add:No.A-6, Qiaoli Industrial Area, Fuding City, Ningde City, Fujian Province,China

ZIP:352000
 Email: info@carbureformfg.com

www.carbureformfg.com

Professional China Manufacture
Marine Outboard Engine Carburetor
 Diaphragm-type Carburetor
 Float -type Carburetor

Tel: 0086-593-7806626
 Fax: 0086-593-7806626